

# Temporary Abutments

PEEK (polyetheretherketone) is a high-grade thermoplastic polymer which is certified for medical use. PEEK is characterized by a superior combination of strength, elasticity and resilience. PEEK is one of the most chemically resistant materials, Biocompatible and esthetic with low electrical conductivity. PEEK polymer is well suited for use in the oral cavity.

*Material: PEEK*

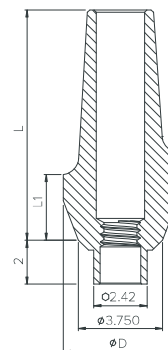

## Technical Data:

- Can be sterilized without changing the mechanical properties or biocompatibility violations.
- Does not create artifacts in X-ray irradiation procedures, magnetic resonance imaging (MRI), and computed tomography (CT).
- Has high compressive strength.
- Possesses excellent mechanical properties such as stiffness and strength.
- Has proven biocompatibility for both hard and soft tissue.
- Does not contain metal additives to prevent ion exchange in the mouth.
- Is a natural color, a superior esthetic advantage.

Straight		Angulated 15°		Angulated 25°	
	L (mm)			L (mm)	L1 (mm)
	9			9.5	1
NM-C6001		NM-C5001	NM-C5201		
	10			10.5	2
NM-C6002		NM-C5002	NM-C5202		
	11			11.5	3
NM-C6003		NM-C5003	NM-C5203		



# Temporary Abutments

The titanium Temporary Abutments are designed with deep retention grooves, for the acrylic prosthesis to hold to.

The abutments are available hexed and non-hexed.

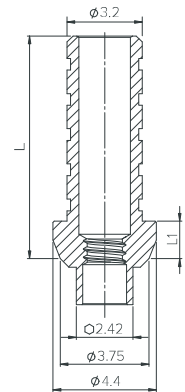
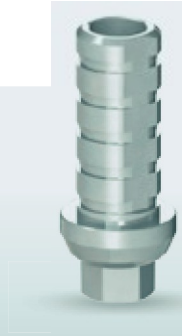
*Material: Titanium (Ti6Al4V ELI)*



Hexed	Non-Hexed	L (mm)	L1 (mm)
		9.5	1.7
NM-A5001	NM-A5002		
	Included with all abutments above & available separately		
NM-S8324			

